

**Square Footage Calculations**

First Floor = 794 SF  
 Second Floor = 794 SF  
 Third Floor = 748 SF

**Total Gross Living Area = 2,336 SF**

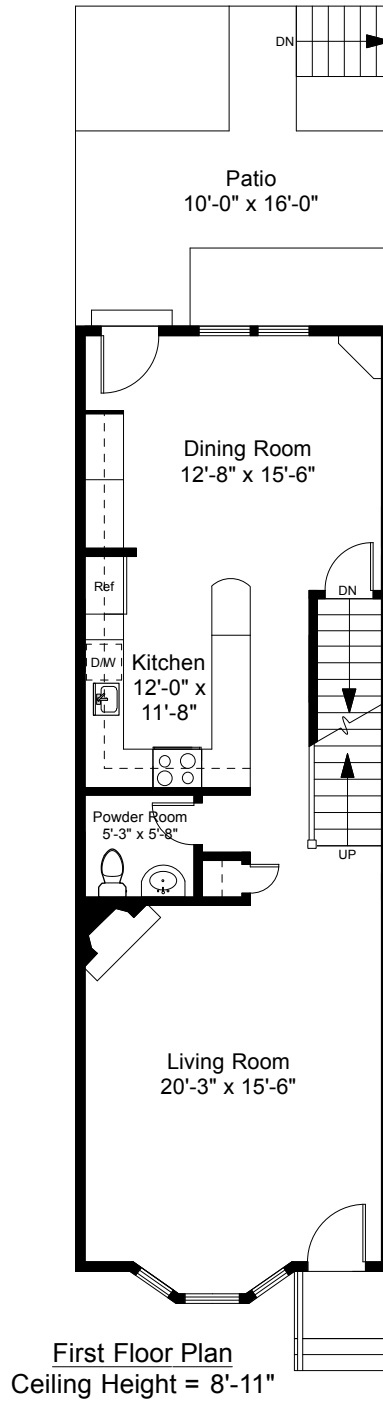
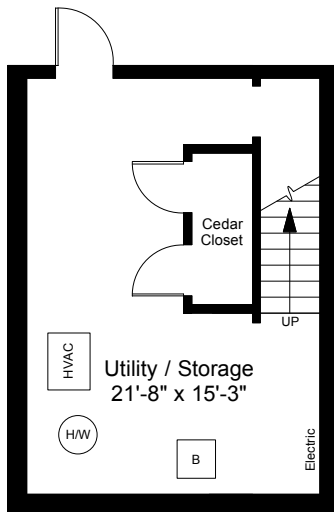

270 Waterman Street, Unit B  
 Providence, RI 02906

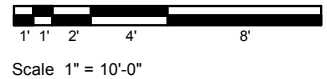

1

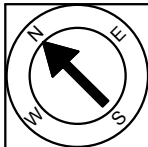

Completed: September 2017

Note: Dimensions are not guaranteed and are provided for informational purposes only. Individual room dimensions are not used to calculate overall square footage.



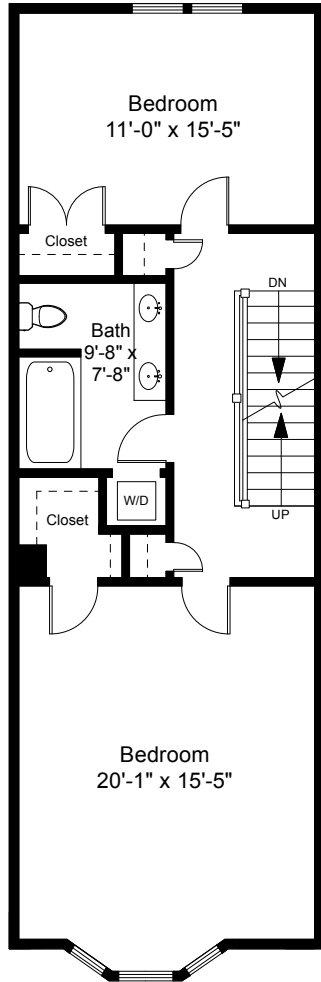

Second Floor Plan  
Ceiling Height = 7'-11"

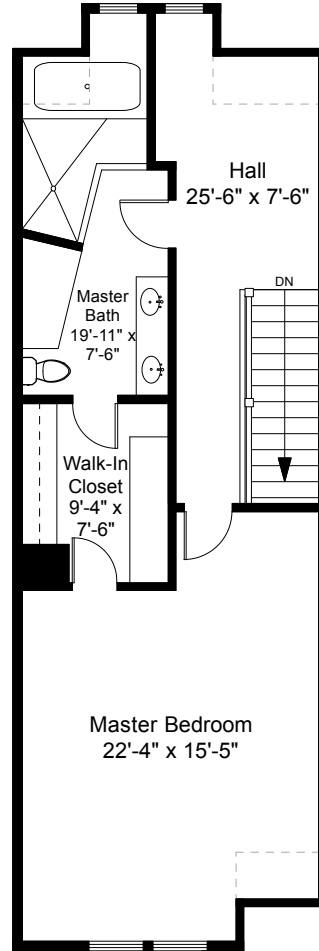

Third Floor Plan  
Ceiling Height = 7'-11"

270 Waterman Street, Unit B  
Providence, RI 02906

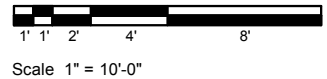

2

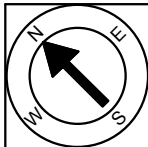

Completed: September 2017

Note: Dimensions are not guaranteed and are provided for informational purposes only. Individual room dimensions are not used to calculate overall square footage.

NATIONAL  
—FLOOR PLANS—  
& PHOTOGRAPHY  
(800) 328-0217